

# VAC KING



**WET/DRY CARPET & UPHOLSTERY CLEANER**

**MODEL NO: CVAC20CCSS**

PART NO: 6471098

## OPERATING & MAINTENANCE INSTRUCTIONS



ORIGINAL INSTRUCTIONS

GC09/23

---

## INTRODUCTION

---

Thank you for selecting this CLARKE carpet and upholstery cleaner, which will provide you with a cleaner and safer working environment.

Before attempting to operate the machine, it is essential that you read this manual thoroughly and carefully follow all instructions given. In doing so you will ensure the safety of yourself and that of others around you, and you can also look forward to the machine giving you long and satisfactory service.

---

## SPECIFICATION

---

MODEL	CVAC20CCSS
Part No	6471098
Weight	7.5 kg
Dimensions (D x W x H) mm	390 x 315 x 480
Water Capacity	15 Litres
Hose length	2100mm
Dust Capacity	18 Litres
Max Airflow	1.73 m <sup>3</sup> /min
Duty Cycle	S1 (continuous)
Power Supply	230 V/50Hz/1ph
Motor Power rating	1.4 kW
IP Rating	IP24
Power cable length	4.43 m

Please note that the details and specifications contained herein, are correct at the time of going to print. However, CLARKE International reserve the right to change specifications at any time without prior notice.

---

# **SAFETY PRECAUTIONS**

---

## **WORK AREA**

1. Avoid operating in the presence of flammable liquids or gases. The motor may produce sparks during operation. **DO NOT** use in enclosed areas where flammable, explosive or toxic vapours are given off.

## **PERSONAL SAFETY**

1. **ALWAYS** stay alert, watch what you are doing and use common sense when operating. **DO NOT** use the machine while you are tired or under the influence of medication, drugs or alcohol. A moment of inattention can result in personal injury.
2. **NEVER** over-reach. Keep your proper footing and balance at all times to enable better control of the machine in unexpected situations.
3. **ALWAYS** store the machine out of reach of children.

## **GENERAL MACHINE USE AND CARE**

1. Prior to use, all users should become familiar with this instruction booklet.
2. **ALWAYS** maintain the machine with care and keep it clean for best / safest performance.
3. **NEVER** use this machine if any part is damaged. Have it inspected and repaired by your **CLARKE** dealer. Do not use if the electric cable, plug, or the machine itself, is in poor condition.
4. **NEVER** abuse the power cable. Never pull on the cable when removing the plug from the socket or lift the machine by the power cable. Take care not to close doors on the cable, or allow it to become snagged under furniture/objects with sharp edges. Keep away from heat or oil.
5. Only use extension leads that are of an appropriate power rating and suitable for the work environment. Extension leads must have an earth connection. Inspect the extension lead regularly and replace if damaged.
6. **ALWAYS** take care when a long hose is required in the work area as it presents a trip hazard. Tidy the hose away when the job is finished.
7. **NEVER** pick up burning cigarettes or other hot or smoking substances.
8. **NEVER** abuse the machine by standing on it.
9. **ALWAYS** transport the machine by lifting it by the handle.

## CARE & STORAGE

1. When not in use, turn off by the On/Off switch on top of the machine and remove the plug from the mains power supply.
2. When you have finished with the machine, ensure the electric cable is stowed away and not left as a trip hazard.
3. DO NOT change filters or carry out any cleaning or servicing, without first disconnecting the machine from the power supply.
4. Keep the external surfaces clean. Avoid impact damage and do not allow the machine to come into contact with abrasive or corrosive materials.
5. DO NOT use solvents, thinners or alcohol to clean the machine, as these chemicals will damage the finish. With the machine unplugged from the power supply, use a dry cloth to wipe over the plastic casing.
6. When not in use the machine should be stored in a secure, dry place, out of the reach of children. DO NOT leave it exposed to the elements and avoid direct sunlight, direct heat, rain/moisture etc.
7. Only use parts and accessories recommended in this manual. The use of unauthorised accessories or attachments is not permitted and may result in personal injury or damage to the machine.
8. DO NOT attempt to repair or modify the machine. Do not attempt any electrical repair yourself. Consult a qualified electrician or the CLARKE Service Department on 020 8988 7400.

## ENVIRONMENTAL PROTECTION



By purchasing this product, the customer is taking on the obligation to deal with its safe disposal in accordance with the Waste Electrical and Electronic Equipment regulations (WEEE).

In effect, this means that this product must not be disposed of with general household waste. It must be disposed of according to the laws governing Waste Electrical and Electronic Equipment (WEEE) at a recognised disposal facility.

## GUARANTEE

This CLARKE product is guaranteed against faulty manufacture for a period of 12 months from the date of purchase. Please keep your receipt as proof of purchase.

This guarantee is invalid if the product is found to have been abused or tampered with in any way, or not used for its intended purpose.

Faulty goods should be returned to their place of purchase, no product can be returned to us without prior permission.

This guarantee does not effect your statutory rights.

## ELECTRICAL CONNECTIONS



**WARNING! READ THESE ELECTRICAL SAFETY INSTRUCTIONS THOROUGHLY BEFORE CONNECTING THE PRODUCT TO THE MAINS SUPPLY.**

Before switching the product on, make sure that the voltage of your electricity supply is the same as that indicated on the rating plate. This product is designed to operate on 230VAC 50Hz. Connecting it to any other power source may cause damage.

This product may be fitted with a non-rewireable plug. If it is necessary to change the fuse in the plug, the fuse cover must be refitted. If the fuse cover becomes lost or damaged, the plug must not be used until a suitable replacement is obtained.

If the plug has to be changed because it is not suitable for your socket, or due to damage, it should be cut off and a replacement fitted, following the wiring instructions shown below. The old plug must be disposed of safely, as insertion into a mains socket could cause an electrical hazard.

### DOUBLE INSULATED APPLIANCE

If the colours of the wires in the power cable of this product do not correspond with the markings on the terminals of your plug, proceed as follows.

- The **Blue** wire must be connected to the terminal marked **N** or coloured **Black**.
- The **Brown** must be connected to the terminal marked **L** or coloured **Red**

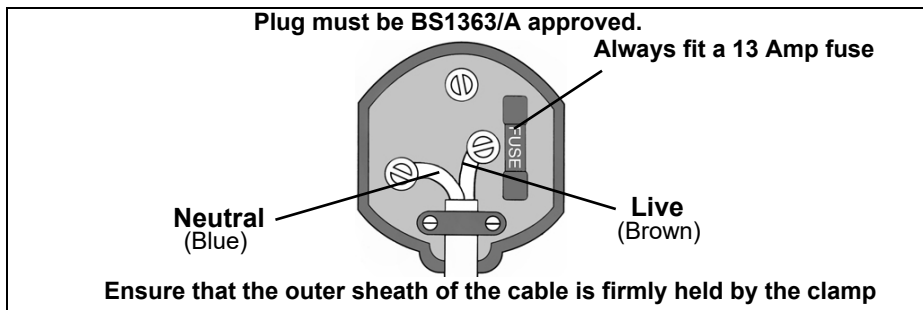

We strongly recommend that this machine is connected to the mains supply via a Residual Current Device (RCD).

If in any doubt, consult a qualified electrician. DO NOT attempt any repairs yourself.

# INVENTORY OF COMPONENTS

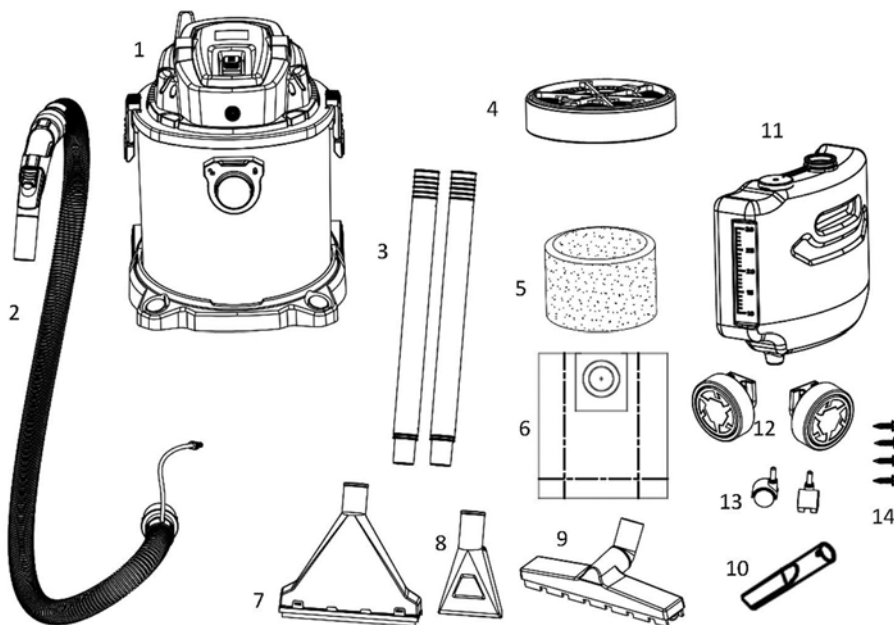

No	Description	No	Description
1	Tank unit	9	Washing Brush (for carpet)
2	Flexible hose & detergent spraygun	10	Wet & Dry Floor Brush
3	2 x Connecting Tubes	11	Crevice Nozzle
4.	HEPA Filter	12	Detergent tank
5	Sponge Filter (optional)	13	Rear wheels
6	Paper Filter	14	Front wheels
7	Cloth Bag (for dry use)	15	Screws for rear wheels
8	Washing Brush (for upholstery)		

---

# PREPARATION FOR USE

---



**WARNING: BEFORE USING THE CVAC, MAKE SURE THAT YOU HAVE READ AND UNDERSTOOD THE SAFETY INSTRUCTIONS**

---

## UNPACKING & ASSEMBLY

With the CVAC removed from the packaging, undo the two clamps securing the head and remove the components from within the tank. Lay them out and check for shortages and that no damage was suffered in transit.

## FITTING THE WHEELS

Press the 2x front wheels into the base position and screw on the rear wheels.

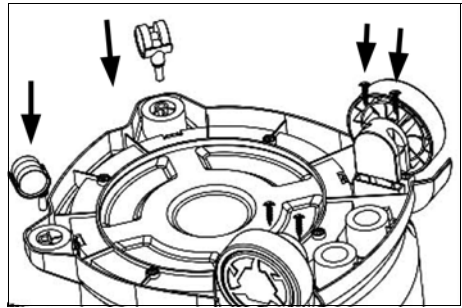

## FITTING THE DETERGENT TANK

Fit the detergent tank to the machine by sitting the feet into the recesses and pressing the body onto the retaining clip on the tank.

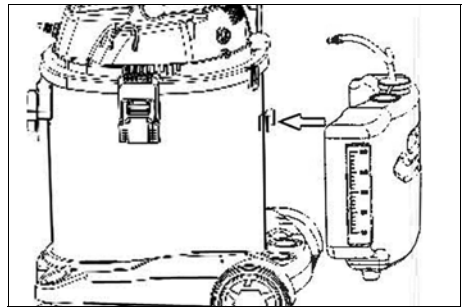

## FITTING THE FILTERS

Filters are essential to ensure that dust or foreign matter does not enter the motor compartment which would reduce motor efficiency and eventually cause serious damage.

1. Fit the HEPA filter or the alternative sponge filter into the top of the water valve housing.

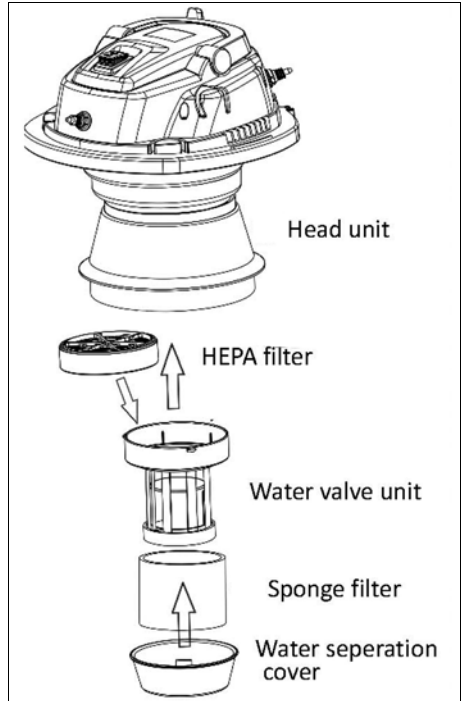

2. Fit the water valve unit complete with sponge filter into the head unit. Turn it clockwise to lock into place.

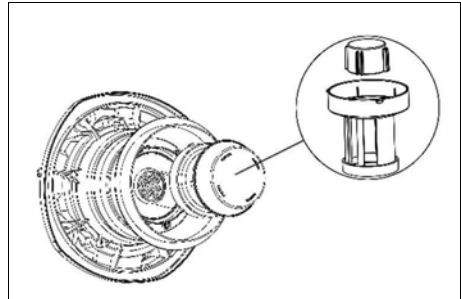

3. Before cleaning dry dust, lock the dust bag onto the suction port on the side of the tank.
4. Clamp the head unit onto the main tank.

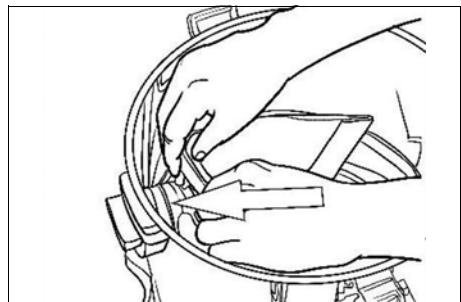



## HOSE, TUBE, BRUSH & DETERGENT PIPE

1. Check the security and tightness of the following connections in case of suction or residue leakage.



2. Connect the hose, tubes and brushes together as shown. Different brushes should be connected with the detergent spray gun to tubes. To connect, twist the hose end clockwise.
3. Fit all the sealing locks for the detergent hose and connectors in the correct position and twist clockwise to secure.

## DETERGENT PIPES

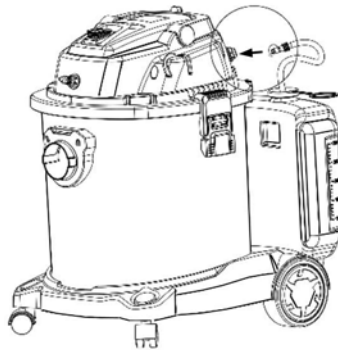
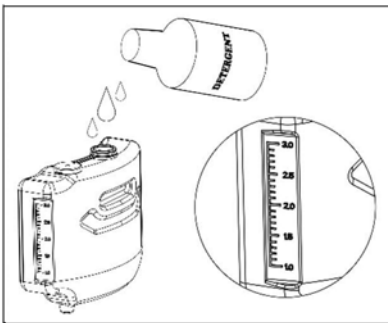
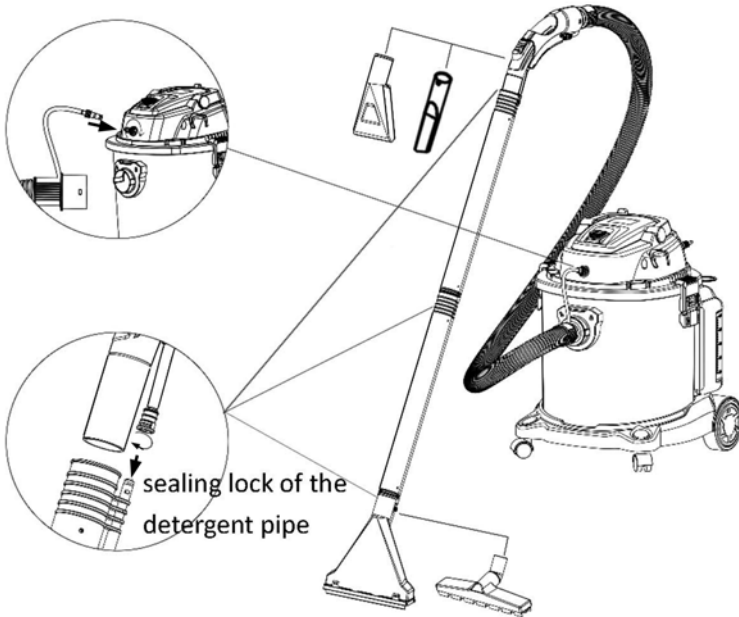

4. Fill the detergent tank with detergent (max volume 3L) using the visual scale on the side of the tank.
  - Thick detergent should be diluted if there is a possibility of clogging the pipe.
  - The detergent level indicator should always be under the opening of the detergent tank or it will be hard to pump the detergent out.

# OPERATION

## SWITCH

Using the (-) symbol the unit works as a common wet/dry vacuum cleaner

Using the SPRAY symbol, the detergent pump and spray gun works.

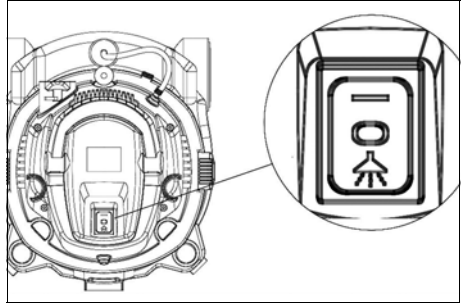

## CARPET AND SOFA WASHING

Choose the corresponding brush for your cleaning tasks. Ensure there is enough detergent in the tank for best performance. **The dust bag must be removed as effluent will ruin it.** Before washing it is better to have a pre-cleaning for coarse dirt as the washing brushes are not able to clean it.

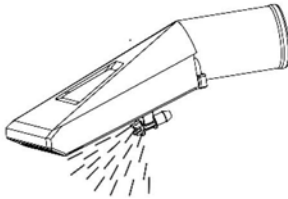

Upholstery attachment

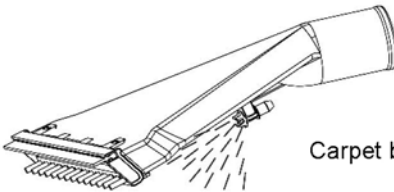

Carpet brush

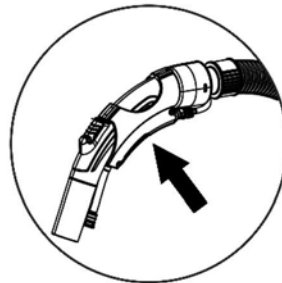

Spray trigger button

Press the button of the detergent spray gun. Detergent will spray out from the spray nozzle of the carpet brush and sofa brush. (allow 10 seconds for the first usage while the detergent is pumped out.

Move the brush on the carpet or sofa surface evenly and slowly, ensuring the detergent is sprayed uniformly.

Brush the carpet or upholstery and vacuum the effluent for effective cleaning.

## FLOOR CLEANING

Use the wet & dry floor brush for cleaning the floor of dust, debris or spillage.

- Use the dust bag for dry use only
- Use either the fine sponge or HEPA filter for dry dust only
- Use the sponge filter for spillage



## AIRFLOW ADJUSTMENT

Slide the switch on the detergent spraygun to adjust the suction.

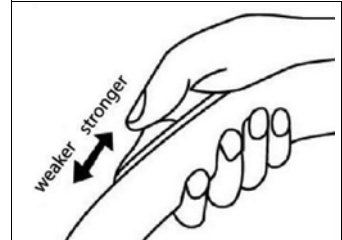

## BLOWING FUNCTION

Insert the end of the plastic hose into the blower and twist clockwise to lock.

Switch on the vacuum cleaner to start the blower.

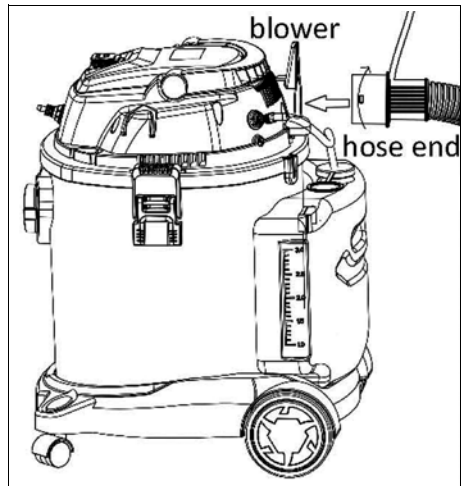

## FILTER CLEANING FUNCTION

The presence of thick dust in the garden, workshop or newly decorated room will cause the filters to clog easily. IN this case, press the filter cleaning button on the back of the unit head several times and the suction power will recover.

Meanwhile when blocking the suction port it will be more effective.

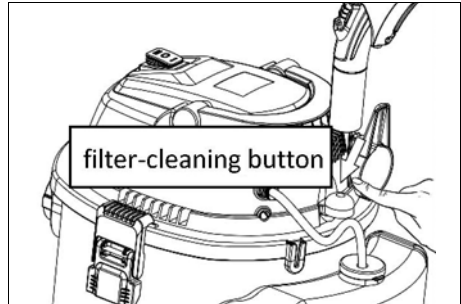

## PROTECTIVE WATER VALVE

When the water container is full, the protective float valve will work and the suction power will vanish. The motor will be heard running at high speed and the water valve will block the air inlet.

When picking up water, the tank will gradually fill up. Check and empty at frequent intervals, otherwise the float valve will rise and shut off the suction.

This is a safety feature to prevent water from coming into contact with electrical components. Should suction stop, you will hear a more urgent sound from the motor. Immediately switch OFF and empty the tank to prevent the motor overheating.

Switch off the power and empty the effluent.

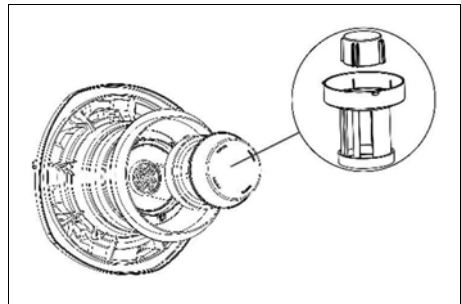

## WORKING PRACTICE

**Before use, open the machine and check that the appropriate filters are securely in place and in good condition.** If the paper bag is full, replace it. Spare bags are available from your CLARKE stockist.

Switch on and start work. The machine should be positioned on a firm, level surface. DO NOT cover the machine and always position it with good all-round ventilation. The machine must remain upright, especially when picking up water/effluent.

When moving the machine:

- Always use the handle.
- DO NOT lift by (or place a strain on) the hoses or cable.
- After use always switch it off and disconnect from the power supply.

## TROUBLESHOOTING

Symptom	Possible Cause	Corrective action
Leaks from hose/tubes/ pipes	Accessories are not installed correctly Rubber seal ring on the detergent pipe is broken or loose.	Follow assembly instructions and check the tightness of all joints. For repairs, contact your dealer.
Weak suction	Filter/tubes/hose or suction port is blocked. Lid not fitted correctly to the tank.	Clean all filters/accessories or use the filter cleaning function. Re-fit the head unit and clamp it correctly to the tank.
Abnormal noise during operation.	Effluent in the tank is excessive and the water valve is operating Unit is not upright and the water valve is operating	Clean out effluent from tank Ensure machine is upright.
Smoke appears from machine	Overheated, over- loaded or damaged motor	Switch off and send for repair.
Effluent or foam is blown out of the blower or the head.	Filters not installed correctly Filters need replacing Too much foam in tank.	Follow assembly instructions and check the tightness of all joints. Replace filters with new. Use low foaming deter- gent and clean effluent and foam from the tank.

---

## **MAINTENANCE**

---

Maintenance is limited to inspecting the filters and replacing if necessary. If the filters become holed or damaged they must be replaced.

The cartridge filter is of paper construction and therefore may not be washed. It may be brushed clean and compressed air set at a low pressure may also be used. The cloth bag may be washed as required and dried before use.

Ensure the hose is kept in good condition. A damaged hose will seriously effect the efficiency of the machine and should be replaced immediately.

Inspect all other components periodically and replace damaged castors or accessories when necessary. Contact your CLARKE dealer for replacements.

Regular inspection and the correct maintenance of the filters will ensure efficient running and prolong the life of your machine.

## **CLEANING**

After extensive work or when the tank is full of dust or effluent which causes the suction to decrease, follow the following cleaning procedure.

1. Unfasten the clips and remove the head unit.
2. Remove the filter bag, empty and clean out the contents of the tank before wiping it dry.
3. Wash and clean the filters including the HEPA (high-efficiency particulate absorbing) and sponge filters which should be dried before the next use. These are consumable spares and should be renewed for the best machine performance.
4. Re-fit all items as described in Assembly.

## **CONSUMABLES**

Replacement Filter Pack - Part No 6500565 is available for this machine.

# COMPONENT PARTS

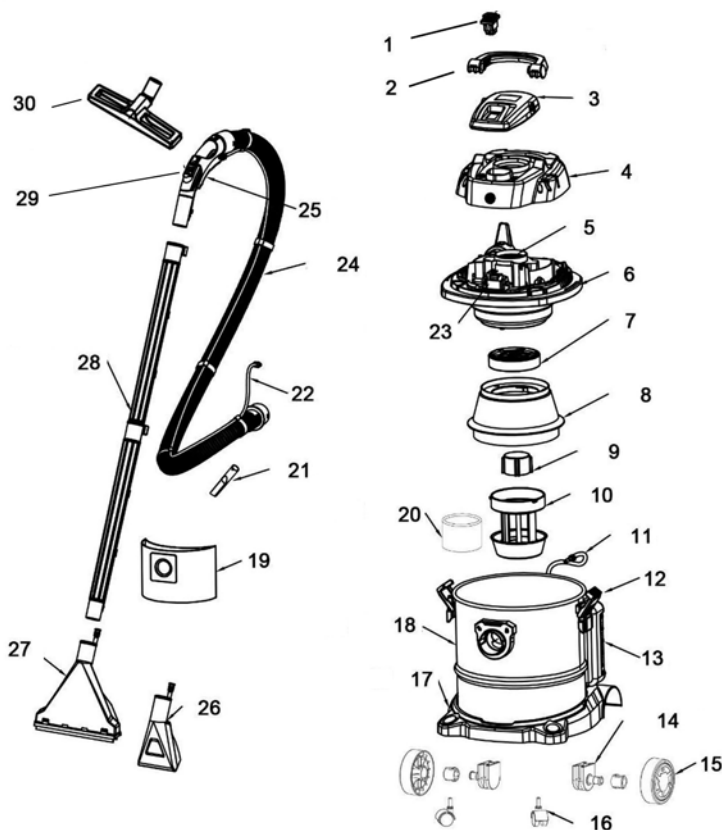

1	Switch	11	Detergent inlet tube	21	Crevice nozzle
2	Handle	12	Clip	22	Detergent tube
3	Top cover	13	Detergent tank	23	Water pump
4	Middle cover	14	Wheel support	24	Hose
5	Motor	15	Rear wheel	25	Spray control
6	Base cover	16	Castor	26	Sofa spray brush
7	HEPA filter	17	Base	27	Carpet brush
8	Cover	18	SS tank	28	Plastic tube
9	Safety valve	19	Paper bag	29	Airflow control
10	Water valve unit	20	Sponge filter	30	Wet/dry floor brush



# DECLARATION OF CONFORMITY-UK



**Clarke**<sup>®</sup>  
**INTERNATIONAL**

Hemnall Street, Epping, Essex, CM16 4LG

## DECLARATION OF CONFORMITY

**This is an important document and should be retained.**

**We hereby declare that this product(s) complies with the following legislation:**

*The Electromagnetic Compatibility Regulations 2016*

*The Electrical Equipment (Safety) Regulations 2016*

*The Restriction of the Use of Certain Hazardous Substances in Electrical and Electronic Equipment Regulations 2012*

**The following standards have been applied to the product(s):**

*EN IEC 55014-1:2021, EN IEC 55014-2:2021, EN IEC 61000-3-2:2019+A1:2021, EN 61000-3-3:2013+A1:2019,*

*EN 60335-1:2012+A11:2014+A13:2017+A1:2019+A14:2019+A2:2019+A15:2021, EN 62233:2008,*

*EN 60335-2-10:2003+A1:2008, EN 60335-2-2:2010+A11:2012+A1:2013, IEC 62321-3-1:2013 Edition 1.0,*

*IEC 62321-4:2017 Edition 1.1, IEC 62321-5:2013 Edition 1.0, IEC 62321-6:2015 Edition 1.0,*

*IEC 62321-7-1:2015 Edition 1.0, IEC 62321-7-2:2017 Edition 1.0, IEC 62321-8:2017 Edition 1.0*

The technical documentation required to demonstrate that the product(s) meet(s) the requirement(s) of the aforementioned legislation has been compiled and is available for inspection by the relevant enforcement authorities.

**The UKCA mark was first applied in: 2023**

**Product Description:** Vacuum Cleaner  
**Model Number(s):** CVAC20CCSS  
**Serial/Batch Number:** Refer to product/packaging label  
**Date of Issue:** 07/08/2023

**Signed:**

**J.A Clarke**

**Director**

# DECLARATION OF CONFORMITY-CE



**Clarke**<sup>®</sup>  
**INTERNATIONAL**

Fitzwilliam Hall, Fitzwilliam Place, Dublin 2

## DECLARATION OF CONFORMITY

**This is an important document and should be retained.**

**We hereby declare that this product(s) complies with the following legislation:**

2014/30/EU                      *Electromagnetic Compatibility Directive*  
2014/35/EU                      *Low Voltage Directive*  
2011/65/EU                      *Restriction of Hazardous Substances (RoHS) Directive*

**The following standards have been applied to the product(s):**

*EN IEC 55014-1:2021, EN IEC 55014-2:2021, EN IEC 61000-3-2:2019+A1:2021, EN 61000-3-3:2013+A1:2019,  
EN 60335-1:2012+A11:2014+A13:2017+A1:2019+A14:2019+A2:2019+A15:2021, EN 62233:2008,  
EN 60335-2-10:2003+A1:2008, EN 60335-2-2:2010+A11:2012+A1:2013, IEC 62321-3-1:2013 Edition 1.0,  
IEC 62321-4:2017 Edition 1.1, IEC 62321-5:2013 Edition 1.0, IEC 62321-6:2015 Edition 1.0,  
IEC 62321-7-1:2015 Edition 1.0, IEC 62321-7-2:2017 Edition 1.0, IEC 62321-8:2017 Edition 1.0*

The technical documentation required to demonstrate that the product(s) meet(s) the requirement(s) of the aforementioned legislation has been compiled and is available for inspection by the relevant enforcement authorities.

**The CE mark was first applied in: 2023**

**Product Description:** Vacuum Cleaner  
**Model Number(s):** CVAC20CCSS  
**Serial/Batch Number:** Refer to product/packaging label  
**Date of Issue:** 07/08/2023

**Signed:**

**J.A Clarke**  
**Director**



# A SELECTION FROM THE VAST RANGE OF

# Clarke®

## QUALITY PRODUCTS



### AIR COMPRESSORS

From DIY to industrial, Plus air tools, spray guns and accessories.

### GENERATORS

Prime duty or emergency standby for business, home and leisure.

### POWER WASHERS

Hot and cold, electric and engine driven - we have what you need

### WELDERS

Mig, Arc, Tig and Spot.  
From DIY to auto/industrial.

### METALWORKING

Drills, grinders and saws for DIY and professional use.

### WOODWORKING

Saws, sanders, lathes, mortisers and dust extraction.

### HYDRAULICS

Cranes, body repair kits, transmission jacks for all types of workshop use.

### WATER PUMPS

Submersible, electric and engine driven for DIY, agriculture and industry.

### POWER TOOLS

Angle grinders, cordless drill sets, saws and sanders.

### STARTERS/CHARGERS

All sizes for car and commercial use.



## PARTS & SERVICE: 0208 988 7400

**Parts Enquiries**  
[Parts@clarkeinternational.com](mailto:Parts@clarkeinternational.com)

**Servicing & Technical Enquiries**  
[Service@clarkeinternational.com](mailto:Service@clarkeinternational.com)

SALES: UK 01992 565333 or Export 00 44 (0)1992 565335

**Clarke** INTERNATIONAL Hemnall Street, Epping, Essex CM16 4LG  
[www.clarkeinternational.com](http://www.clarkeinternational.com)